

# MAGNETIC DRILLING MACHINE



## “ONLY THE BEST”

MD40 - MD50 - MDT55 - MD108

MAGTAP30 - MDT140

The new Magbroach magnetic core drilling machines offer a complete bandwidth of machines in the pro segment for many different areas of use in steel construction. Development and selection of the components of the new machine generation was subject to the principle "ONLY THE BEST" to warrant longevity, high-quality processing and thus a low maintenance effort. Eibenstock high-performance motors "100% MADE IN GERMANY" contribute to outstanding torques.



**Magbroach (UK) Ltd**

Unit 1, Hardwick Court, Holmewood, Chesterfield, S42 5SA

Tel: 01246 224669 - Fax: 01246 224670

Website: [www.magbroachuk.com](http://www.magbroachuk.com)

# MAGNETIC DRILLING MACHINE

## MODEL: MD40



Core drilling

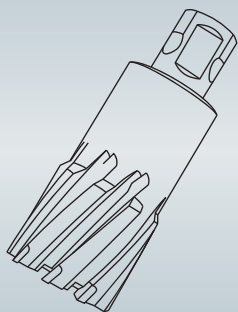

Ø 12 - 40 mm

Twist drilling

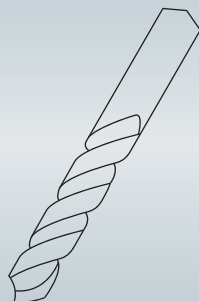

Ø 3 - 16 mm

Countersinking

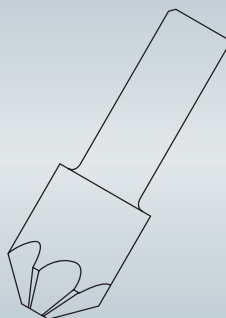

Ø 10 - 30 mm

Thanks to "HEAVY-DUTY" Twin Rail Slide System easily 110 mm cutting depth possible.

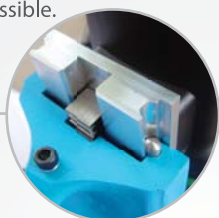

Most wanted magnetic drilling machine, light as a feather! The MD40 is standard equipped with a strong magnet, newest electronics, auto coolant system and of course powered by a highly reliable 1100 watt motor supplied by Eibenstock. Weight only 11.5 Kg.



Gear stages  
Speed full load  
① = 450 min<sup>-1</sup>

### MODEL: MD40

CUTTER CAPACITY	12 - 40 mm
DRILLING CAPACITY	3 - 16 mm
COUNTERSINK CAPACITY	10 - 30 mm
MOTOR WATTS	1100 W
TOTAL POWER WATTS	1150 W
SPEED NO LOAD RPM	720 RPM
SPEED FULL LOAD	450 RPM
ARBOR/DRIVE WELDON	19 mm
SLIDE STROKE	170 mm
MAGNETIC ADHESION	1100 kg
MAGNETIC FOOT	85x170 mm
MAGNET	FIXTED
OVERALL HEIGHT	320 mm
OVERALL WIDTH	120 mm
OVERALL LENGTH	280 mm
ARBOR FOR CUTTERS	19 mm
COOLANT SYSTEM	THROUGH ARBOR
WEIGHT	11.5 kg

\*\* All machines supplied in plastic carry case with allen keys / safety chain with carabina hook / coolant system all models available in 110/120 Volts 50/60Hz and 220/240 Volts AC 50/60Hz

\* 12 months comprehensive warranty as standard.

\* Optional swivel base: Model MDS 40

# Magbroach (UK) Ltd

Agent:

# MAGNETIC DRILLING MACHINE

## MODEL: MD50



Core drilling

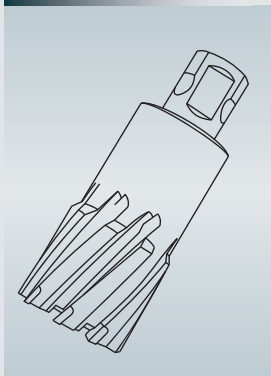

Ø 12 - 50 mm

Twist drilling

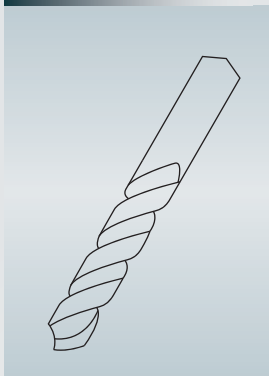

Ø 3 - 23 mm

Countersinking

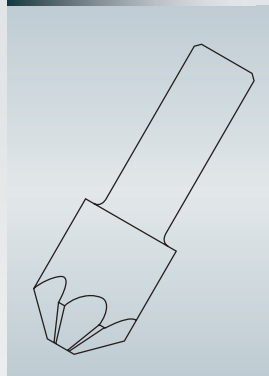

Ø 10 - 40 mm

Thanks to "HEAVY-DUTY" Twin Rail Slide System easily 110 mm cutting depth possible.



\*\* All machines supplied in plastic carry case with allen keys / safety chain with carabina hook / coolant system and drill drift MT 2 all models available in 110/120 Volts 50/60Hz and 220/240 Volts AC 50/60Hz

To MD50 magnetic drilling machine, the all-rounder. The exchangeable Morse taper 2 makes this magnetic drilling machine an all-round machine for all drilling purposes. This machine is supplied with auto coolant system as standard. This magnetic drilling machine is powered by a strong 1150 watt Eibenstock motor.



Gear stages  
Speed full load  
1 = 250 min<sup>-1</sup>  
2 = 450 min<sup>-1</sup>



### MODEL: MD50

CUTTER CAPACITY	12 - 50 mm
DRILLING CAPACITY	3 - 23 mm
COUNTERSINK CAPACITY	10 - 40 mm
MOTOR WATTS	1150 W
TOTAL POWER WATTS	1200 W
SPEED 2 NO LOAD RPM	465/720 RPM
SPEED 2 FULL LOAD RPM	250/450 RPM
ARBOR/DRIVE WELDON	MT2
SLIDE STROKE	170 mm
MAGNETIC ADHESION	1250 kg
MAGNETIC FOOT	85x180 mm
MAGNET	FIXTED
OVERALL HEIGHT	410mm
OVERALL WIDTH	120 mm
OVERALL LENGTH	280 mm
ARBOR FOR CUTTERS	19 mm WELDON
COOLANT SYSTEM	THROUGH ARBOR
WEIGHT	14 kg

\* 12 months comprehensive warranty as standard.

\* Optional swivel base: Model MDS 50

# Magbroach (UK) Ltd

Agent:



# MAGNETIC DRILLING MACHINE

## MODEL: MDT55



Core drilling

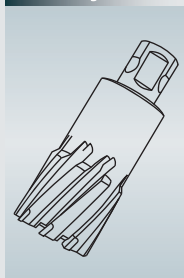

Ø 12 - 55 mm

Twist drilling

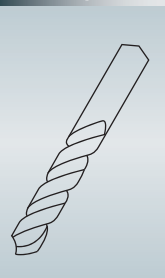

Ø 3 - 23 mm

Countersinking

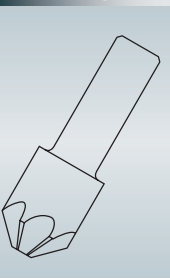

Ø 10 - 40 mm

Tapping

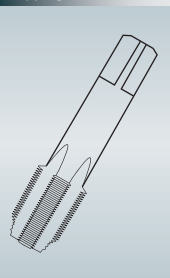

Ø 6 - 20 mm

Thanks to "HEAVY-DUTY" Twin Rail Slide System easily 110 mm cutting depth possible.



MDT55 magnetic drilling machine, versatility in a compact form. The exchangeable Morse taper 2 makes this magnetic drilling machine an all-round machine for all drilling purposes. The variable speed and right/left option enable this magnetic drilling machine to also be used for tapping / threading up to M20, reaming and countersinking. This machine is supplied with auto coolant system as standard. This magnetic drilling machine is powered by a strong 1250 watt Eibenstock motor.

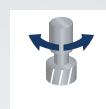

Right/left running



Full wave electronic



Thermal/overheat protection



Gear stages

Speed full load

1 = 100-250 min<sup>-1</sup>

2 = 180-450 min<sup>-1</sup>



### MODEL: MDT55

CUTTER CAPACITY	12 - 55 mm
DRILLING CAPACITY	3 - 23 mm
TAPPING CAPACITY	6 - 20 mm
COUNTERSINK CAPACITY	10 - 40 mm
MOTOR WATTS	1250 W
TOTAL POWER WATTS	1300 W
SPEED 2 NO LOAD RPM	465/720 RPM
SPEED 2 FULL LOAD RPM	250/450 RPM
ARBOR/DRIVE	MT2
SLIDE STROKE	170 mm
MAGNETIC ADHESION	1250 kg
MAGNETIC FOOT	85x180 mm
MAGNET	FIXTED
OVERALL HEIGHT	420 mm
OVERALL WIDTH	120 mm
OVERALL LENGTH	280 mm
ARBOR FOR CUTTERS	19 mm WELDON
COOLANT SYSTEM	THROUGH ARBOR
WEIGHT	15 kg

\*\* All machines supplied in plastic carry case with allen keys / safety chain with carabina hook / coolant system and drill drift MT 2 all models available in 110/120 Volts 50/60Hz and 220/240 Volts AC 50/60Hz

\* 12 months comprehensive warranty as standard.

\* Optional swivel base: Model MDT S 55

# Magbroach (UK) Ltd

Agent:

# MAGNETIC DRILLING MACHINE

## MODEL: MD108



Core drilling

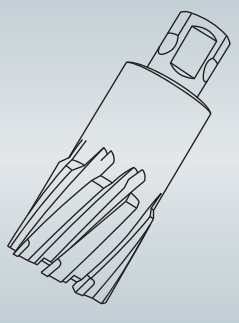

Ø 12 - 100 mm

Twist drilling

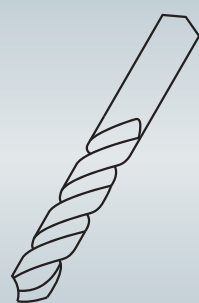

Ø 3 - 32 mm

Countersinking

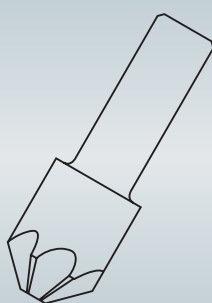

Ø 10 - 55 mm

Thanks to "HEAVY-DUTY" Twin Rail Slide System easily 200 mm cutting depth possible.

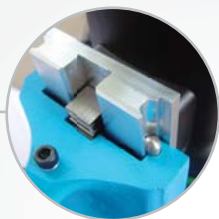

\*\* All machines supplied in plastic carry case with allen keys / safety chain with carabina hook / coolant system and drill drift MT 3 all models available in 110/120 Volts 50/60Hz and 220/240 Volts AC 50/60Hz

MD108 magnetic drilling machine, suited for any task you can think off. A more complete machine you cannot wish for. With the exchangeable Morse taper 3 makes you can drill with hole cutters up to Ø 100 mm, use twist drills up to Ø 32 mm. This machine is supplied with auto coolant system as standard. This magnetic drilling machine is powered by a strong 1700 Watt Eibenstock motor.



### MODEL: MD108

CUTTER CAPACITY	12 - 100 mm
DRILLING CAPACITY	3 - 32 mm
COUNTERSINK CAPACITY	10 - 55 mm
REAMING CAPACITY	6 - 26 mm
MOTOR WATTS	1700 W
TOTAL POWER WATTS	1760 W
SPEED 4 NO LOAD RPM	215/330/460/680
SPEED 4 FULL LOAD RPM	110/175/245/385
MECHANICAL CLUTCH	YES
ARBOR/DRIVE	MT3
SLIDE STROKE	255 mm
MAGNETIC ADHESION	2050 kg
MAGNETIC FOOT	102x212 mm
MAGNET	FIXTED
OVERALL HEIGHT	480 mm
OVERALL WIDTH	130 mm
OVERALL LENGTH	340 mm
ARBOR FOR CUTTERS	19 mm WELDON
COOLANT SYSTEM	THROUGH ARBOR
WEIGHT	23 kg

\* 12 months comprehensive warranty as standard.

\* Optional swivel base: Model MDS 132

# Magbroach (UK) Ltd

Agent:

# MAGNETIC DRILLING MACHINE

## MODEL: MAGTAP30 (MT30)



Core drilling

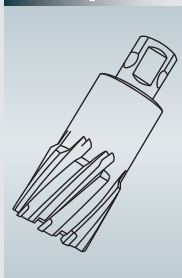

Ø 12 - 100 mm

Twist drilling

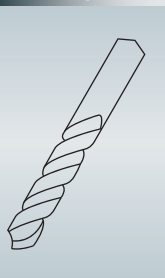

Ø 3 - 32 mm

Countersinking

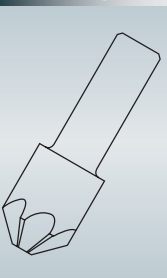

Ø 10 - 55 mm

Tapping

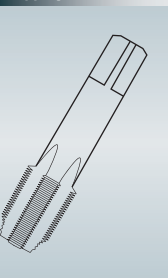

Ø 6 - 30 mm

Thanks to "HEAVY-DUTY" Twin Rail Slide System easily 240 mm cutting depth possible.

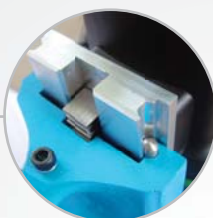

\*\* All machines supplied in plastic carry case with allen keys / safety chain with carabina hook / coolant system and drill drift MT 3 all models available in 110/120 Volts 50/60Hz and 220/240 Volts AC 50/60Hz

Magtap 30 switch panel with fullwave electronic speed control with constant torque also forward and reverse with built in time delay for motor start giving motor and gearbox protection when switching from forward operation to reverse operation when tapping or reaming.



Right/left running



Full wave electronic



Thermal/overheat protection



Gear stages

Speed full load

① = 60 - 140 min<sup>-1</sup>

② = 200 - 470 min<sup>-1</sup>



### MODEL: MAGTAP30 (MT30)

CUTTER CAPACITY	12 - 100 mm
DRILLING CAPACITY	3 - 32 mm
TAPPING CAPACITY	6 - 30 mm
COUNTERSINK CAPACITY	10 - 55 mm
REAMING CAPACITY	6 - 30 mm
MOTOR WATTS	1800 W
TOTAL POWER WATTS	1860 W
SPEED LOW GEAR RPM	60 - 140 RPM
SPEED HIGH GEAR RPM	200 - 470 RPM
MECHANICAL CLUTCH	YES
ARBOR/DRIVE	MT3
SLIDE STROKE	255 mm
MAGNETIC ADHESION	2050 kg
MAGNETIC FOOT	102x212 mm
MAGNET	FIXTED
OVERALL HEIGHT	480 mm
OVERALL WIDTH	130 mm
OVERALL LENGTH	340 mm
ARBOR FOR CUTTERS	19 mm WELDON
COOLANT SYSTEM	THROUGH ARBOR
WEIGHT	23 kg

\* 12 months comprehensive warranty as standard.

# Magbroach (UK) Ltd

Agent:



# MAGNETIC DRILLING MACHINE

## MODEL: MDT140



Core drilling

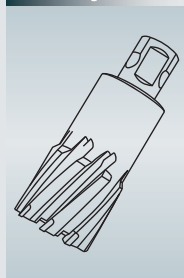

Ø 12 - 140 mm

Twist drilling

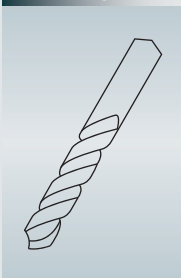

Ø 3 - 50 mm

Countersinking

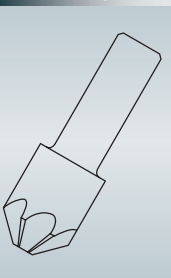

Ø 10 - 80 mm

Tapping

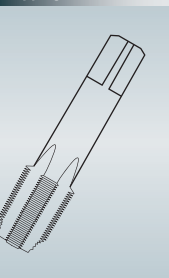

Ø 6 - 44 mm

Thanks to "HEAVY-DUTY" Twin Rail Slide System easily 240 mm cutting depth possible.

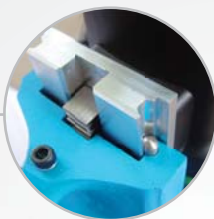

\*\* All machines supplied in plastic carry case with allen keys / safety chain with carabina hook / coolant system and drill drift MT 4 all models available in 110/120 Volts 50/60Hz and 220/240 Volts AC 50/60Hz

### The strongest machine on the market

- \* Drilling up to ø 140 mm
- \* MT 4 Motor, output of 2300 Watt



Right/left running



Full wave electronic



Thermal/overheat protection



Gear stages  
Speed full load

- ① = 30 - 80 min<sup>-1</sup>
- ② = 50 - 120 min<sup>-1</sup>
- ③ = 130 - 350 min<sup>-1</sup>
- ④ = 210 - 550 min<sup>-1</sup>

## MODEL: MDT140

CUTTER CAPACITY	12 - 140 mm
DRILLING CAPACITY	3 - 50 mm
TAPPING CAPACITY	6 - 44 mm
COUNTERSINK CAPACITY	10 - 80 mm
MOTOR WATTS	2300 W
SPEED 1 RPM	30 - 80 RPM
SPEED 2 RPM	50 - 120 RPM
SPEED 3 RPM	130 - 350 RPM
SPEED 4 RPM	210 - 550 RPM
MECHANICAL CLUTCH	YES
ARBOR/DRIVE	MT4
SLIDE STROKE	320 mm
MAGNETIC ADHESION	2675 kg
MAGNETIC FOOT	120x240 mm
OVERALL HEIGHT	556 mm
OVERALL WIDTH	230 mm
OVERALL LENGTH	440 mm
ARBOR FOR CUTTERS	31.75 mm WELDON
COOLANT SYSTEM	THROUGH ARBOR
WEIGHT	35 kg

\* 12 months comprehensive warranty as standard.

# Magbroach (UK) Ltd

Agent:

# MAGNETIC DRILLING MACHINE



**1** This starts with the most important, THE MOTOR. Eibenstock motors 100% Made in Germany are and will remain the best choice when it comes to performance and reliability, motors with high torque and low maintenance.

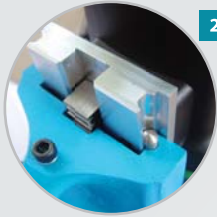

**2** This goes on with the slide. Our "HEAVY-DUTY" Twin Rail Slide System (patent pending) is by far superior to standard dovetail slides in the points of stability and precision.



**3** The heart of our magnetic hole cutting machines robust electronic switching units with ergonomically designed switch panels. Controlled by Hightech P.C.B Electronic circuitry built with safety in mind. We have interlocking systems ensuring that magnet must be energized before motor can be started. This high-tech P.C.B control system is common to all models.



**4** All models of machines are equipped with a rear stabilizer for even more holding power and stability.



**5** Removable coolant tank for external mounting with magnetic clip supplied. Coolant tank with quick release hose system and coolant fine adjustment. Well thought out and practical.



**6** Compact and robust main body housing made of High Grade Cast Aluminium.



**7** All machines equipped with automatic internal coolant supply through 19mm (3/4") Weldon or 32mm (1 1/4") Weldon arbors.

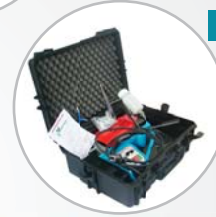

**8** Consistently only the best transport/storage boxes. All machines supplied in heavy-Duty, dust and water-proof sealed boxes with internal protective lining. Ideal protection of machines in tough conditions.

## HEAVY-DUTY TWIN RAIL SLIDE SYSTEM

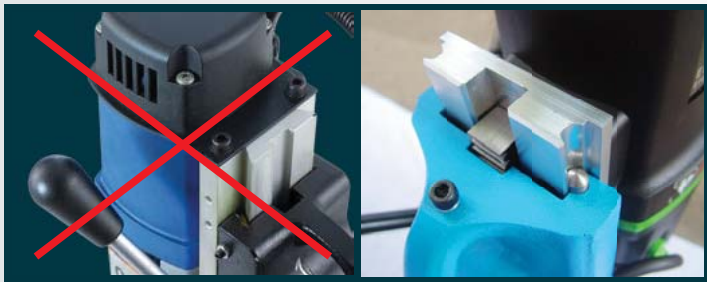

**Advantages of New Twin Rail Slide System "HEAVY-DUTY" over machines with old dovetail system.**

- Up to 10 times better stability.
- Extremely tight tolerances of the slide through the round Twin Rail system.
- The slide has no contact with the main body of the machine. The whole construction is connected only by the highly precise and extremely stable rail system.
  - Reduced friction / less wear
  - Low maintenance / better reliability

### Result:

- Improved cutter life
- Reduced cutter breakage
- Improved hole tolerances
- Improved hole surface quality

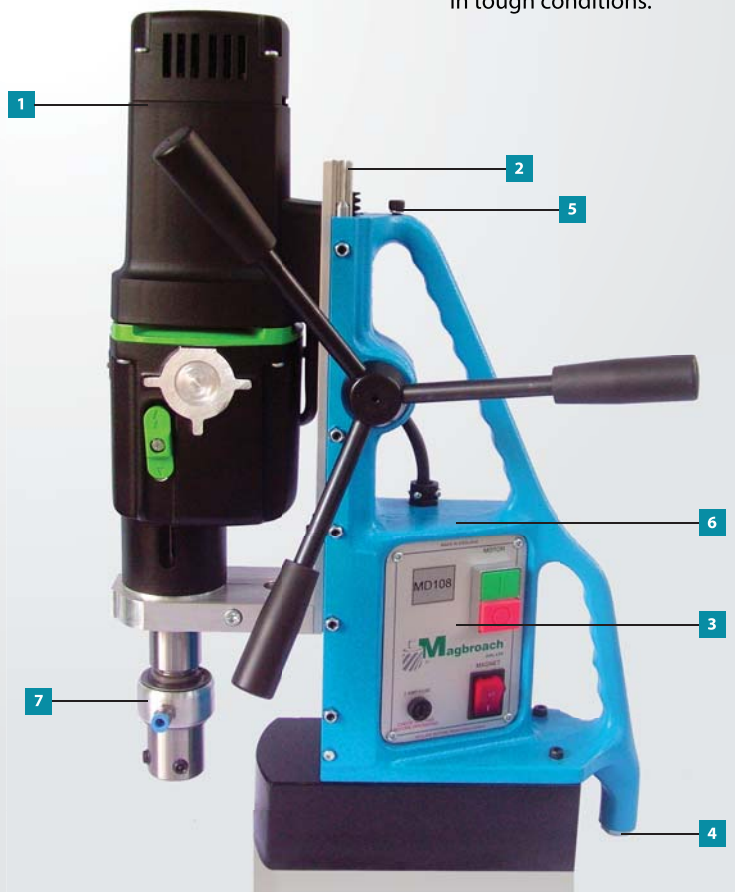

# Magbroach (UK) Ltd

Agent: